

Save this manual for future reference.

## Beaver Pro™

Owner's Manual

Model:  
Arctic Cat  
Prowler Cab Kit \*

### Caution:

Before using this product, read this manual and follow all Safety Instructions.

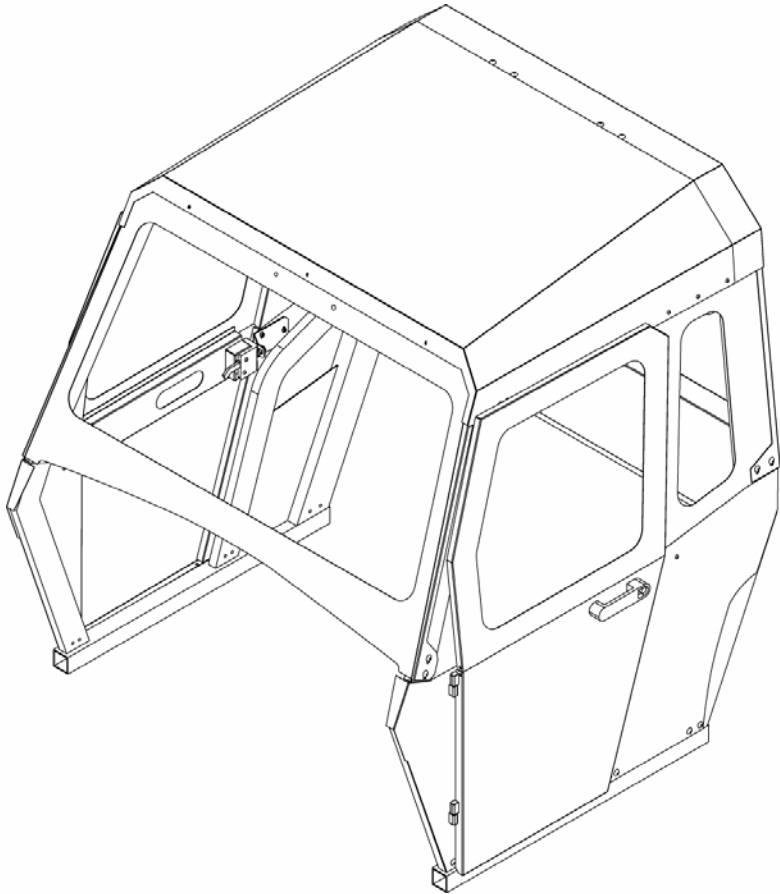

## Arctic Cat Prowler Cab\*

- Safety Instructions
- Cab Kit Contents
- Hardware Assembly
- Panel Assembly
- Operation
- Replacement Parts

\*The Beaver Pro cabs and accessories are in no way affiliated with Arctic Cat Inc. Any use of the Arctic Cat name is only to identify their utility vehicle as it pertains to our accessories. Arctic Cat and Prowler are registered trademarks of the Arctic Cat Company.

Warning: Failure to heed all safety and operating instructions and warnings regarding use of this product can result in serious bodily injury.

## **SAFETY INSTRUCTIONS**

Read entire assembly instructions before beginning work.

Install all parts indicated in assembly instructions. Failure to fully assemble product before use could result in personal injury.

Assembly of product requires use of hand or power tools. If you are not experienced in using these types of tools, have product dealer do the install for you.

Some parts contain sharp edges as indicated in the manual. Wear protective gloves if necessary.

Dress for safety. DO NOT wear loose clothing, gloves, neckties or jewelry if using power tools to assemble this product.

Always keep your assembly area clean, uncluttered and well lit.

Keep visitors and children a safe distance away from the assembly area. Visitors should wear the same safety equipment described above.

Never operate your ATV with the cab doors open. Failure to properly latch the doors before moving the vehicle could result in serious injury.

# CAB KIT CONTENTS

Your BeaverPro™ Artic Cat Prowler cab kit should contain the parts listed below. Separate all parts from packing materials. Do not discard packing material until assembly is complete. Item quantities are listed in parenthesis below.

## Panels and Doors

- Roof Panel (x1)
- Rear Panel (x1)
- Windshield Panel (x1)
- Front Driver Side Panel (x1)
- Front Passenger Side Panel (x1)
- Rear Driver Side Panel (x1)
- Rear Passenger Side Panel (x1)
- Driver Side Door (x1)
- Passenger Side Door (x1)
- Front Cover Plate (x2)
- Rear Cover Plate (x2)
- Small Plug (x1)
- Large Plug (x1)
- 10-32 x 1/4" Screws (x16)
- 10-32 x 3/4" Screws (x17)
- 10-32 x 1/2" Screws (x6)
- 10-32 Nylon Lock Nuts (x39)
- M6 x 16mm Screw (x6)
- Round spacer 10mm ID x 12mm long (x4)
- Sealing Gasket (25ft)

## Hardware

- Hinges (x4)
- Latches (x2)
- Latch Bolts (x2)
- Striker Plates (x2)
- Handle (x2)
- Handle Shim (x2)
- Keys (x4)
- Large Protective Trim (25ft)
- Small Protective Trim (5ft)



# TOOLS REQUIRED FOR ASSEMBLY

Ensure that you have the following tools available before you begin the assembly of your BeaverPro™ Artic Cat Prowler cab kit. Note: Assembly requires two people.

- Phillips Screwdriver
- Torx T-30 Screwdriver
- 3/8" Wrench
- Electric drill and 13/64" drill bit
- Utility knife
- Rubber Mallet
- Aviation Snips
- Wire Cutters
- Masking tape

# HARDWARE ASSEMBLY

In this section, you will be instructed on how to pre-assemble all hardware onto the panels prior to the panel assembly. The hardware assembly should take about 1 hour to complete.

## 1. Assemble Hinges

a) Install hinges pin on front driver side panel using four (4) 10-32 x  $\frac{1}{4}$ " screws and four (4) 10-32 nylon lock nuts. Ensure hinge is oriented as shown in figure to the right.

b) Install hinges on front passenger side panel using four (4) 10-32 x  $\frac{1}{4}$ " screws and four (4) 10-32 nylon lock nuts. Ensure hinge is oriented as shown in figure to the right.

c) Install hinges on driver side door using four (4) 10-32 x  $\frac{1}{4}$ " screws and four (4) 10-32 nylon lock nuts. Ensure hinge is oriented as shown in figure to the right.

d) Install hinges on passenger side door using four (4) 10-32 x  $\frac{1}{4}$ " screws and four (4) 10-32 nylon lock nuts. Ensure hinge is oriented as shown in figure to the right.

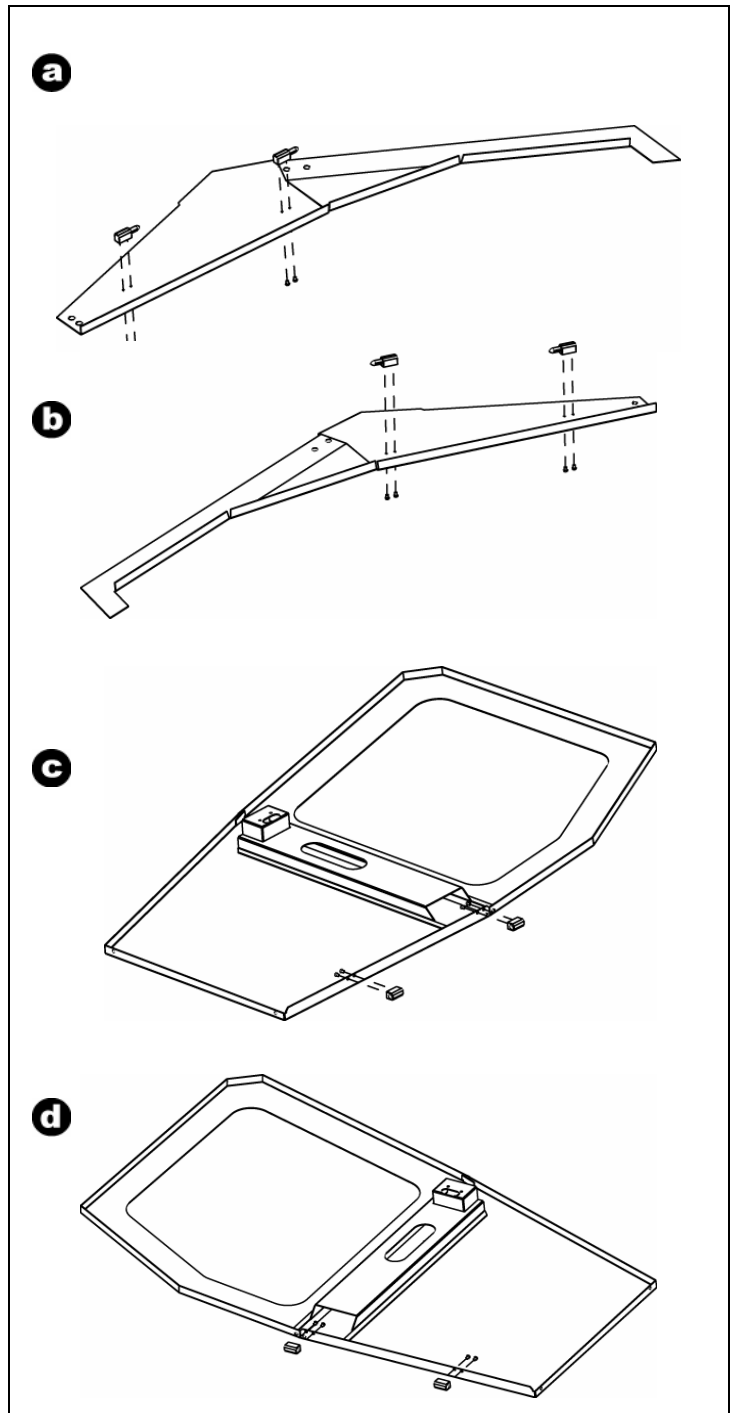

## 2. Install Striker Plates and Latch Bolts

a) Install striker plate on rear driver side panel using three (3) 10-32 x 1/2" screws and three (3) 10-32 nylon lock nuts. Note: Do not completely tighten screws. Striker plate will be adjusted in a following assembly step.

b) Install striker plate on rear passenger side panel using three (3) 10-32 x 1/2" screws and three (3) 10-32 nylon lock nuts. Note: Do not completely tighten screws. Striker plate will be adjusted in a following assembly step.

c) Install latch bolts as shown in figure on the right. Note: Do not completely tighten latch bolt. Latch bolt will be adjusted in a following assembly step.

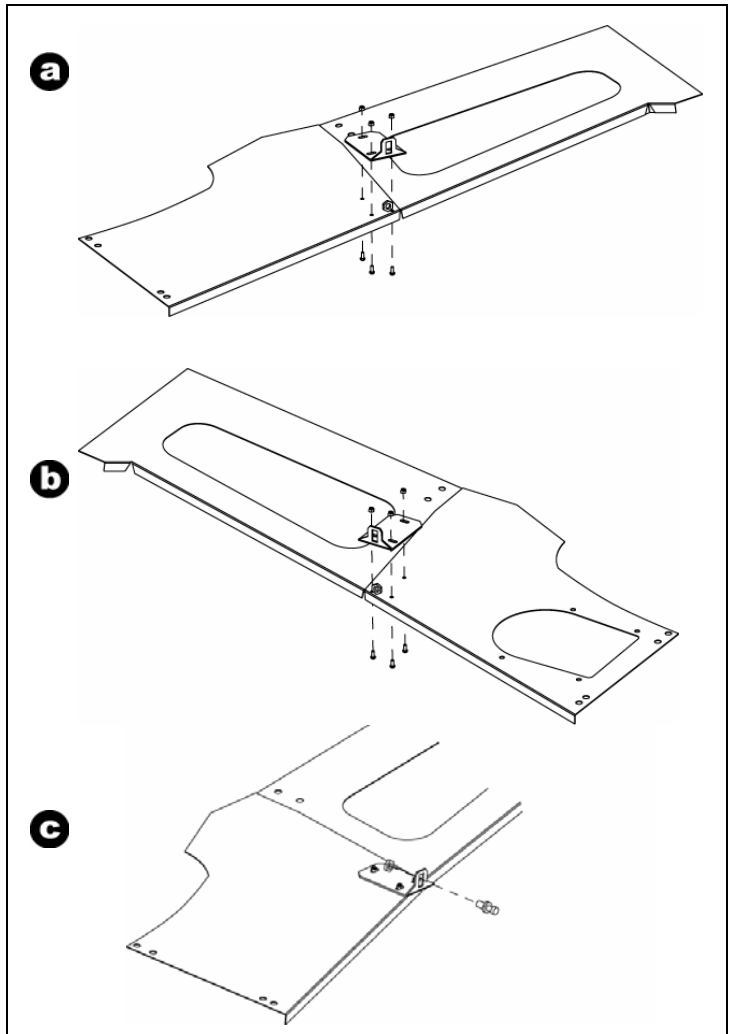

## 3. Install Plugs and Small Protective Trim

a) If you did not order a BeaverPro electric wiper option with your Prowler cab kit, install the small plug and the large plug as shown in figure.

b) Install small protective trim to bottom of windshield panel as shown. Cut from length of trim provided

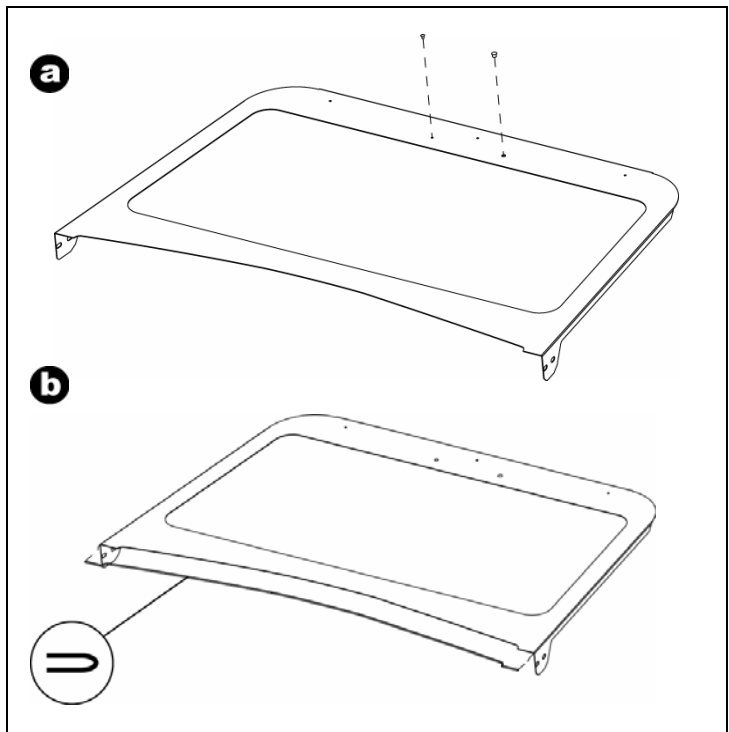

#### 4. Install Door Handles

a) Install door handle on driver and passenger doors using three (3) M6 x 16mm screws per handle.

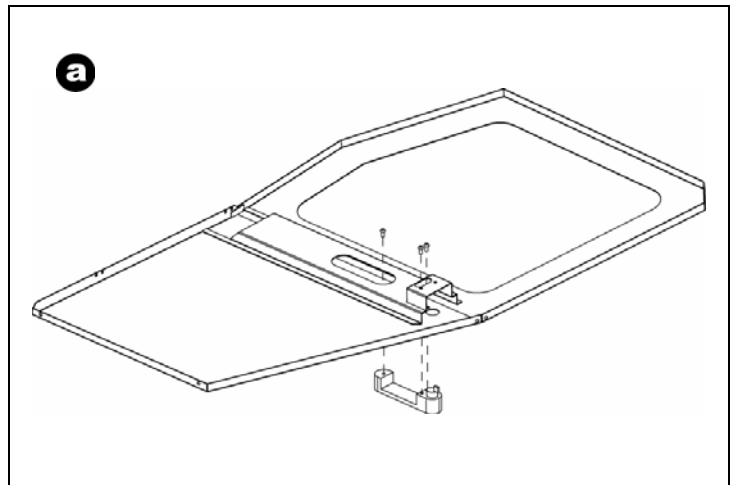

#### 5. Install Latches

b) Install door latch on driver side door using two (2) 10-32 x  $\frac{3}{4}$ " screws, two (2) 10-32 nylon lock nuts and one latch shim. Orient parts as shown in figure.

*Helpful Hint: A loop of masking tape on the end of your index finger can facilitate the positioning of the nut.*

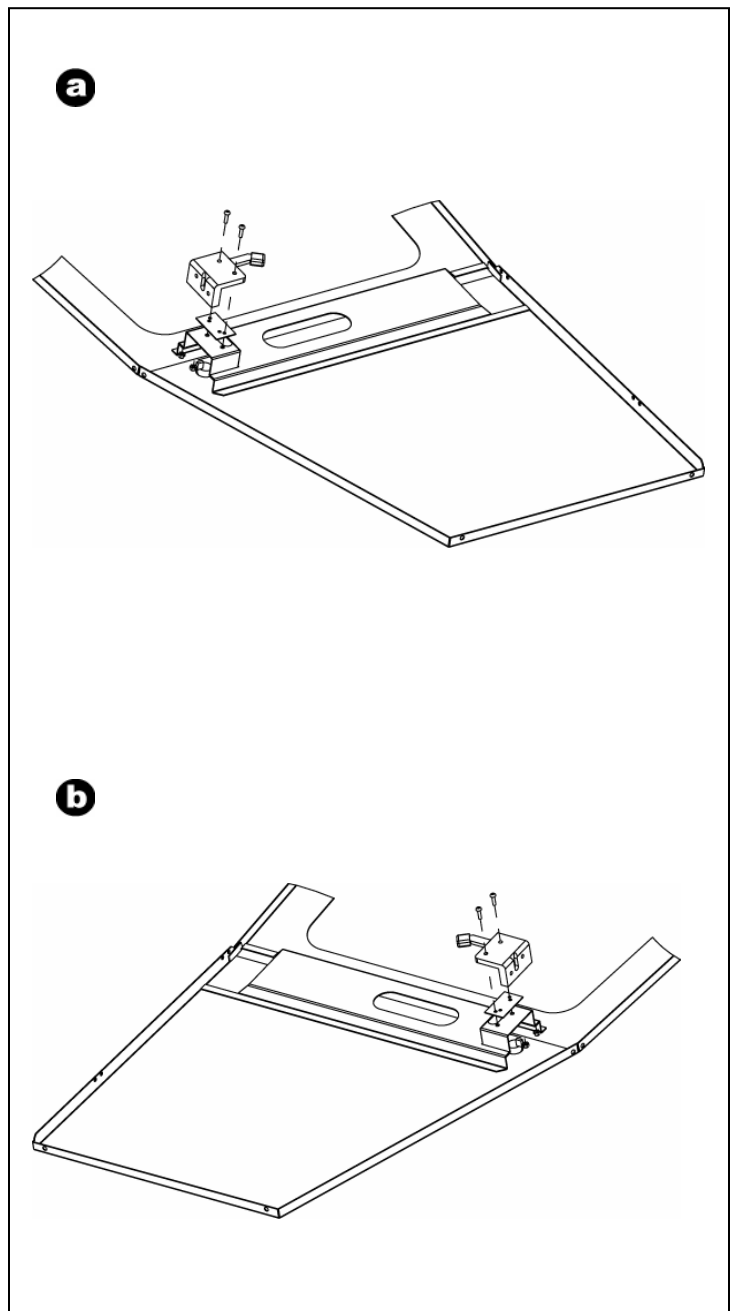

c) Install door latch on passenger side door using two (2) 10-32 x  $\frac{3}{4}$ " screws, two (2) 10-32 nylon lock nuts and one latch shim. Orient parts as shown in figure.

# PANEL ASSEMBLY

## 6. Install Front Side Panels

a) Before installing the front side panels, removed the 8 machine screws from the roll bar as shown using T-30 Torx screwdriver. Do not discard screws. They are re-installed in a later assembly step.

b) Install front driver side panel using two (2) machine screws previously removed. Note: Do not install remaining two screws yet. These will be installed after the windshield panel is assembled.

c) Install front passenger side panel using two (2) machine screws previously removed. Note: Do not install remaining two screws yet. These will be installed after the windshield panel is assembled.

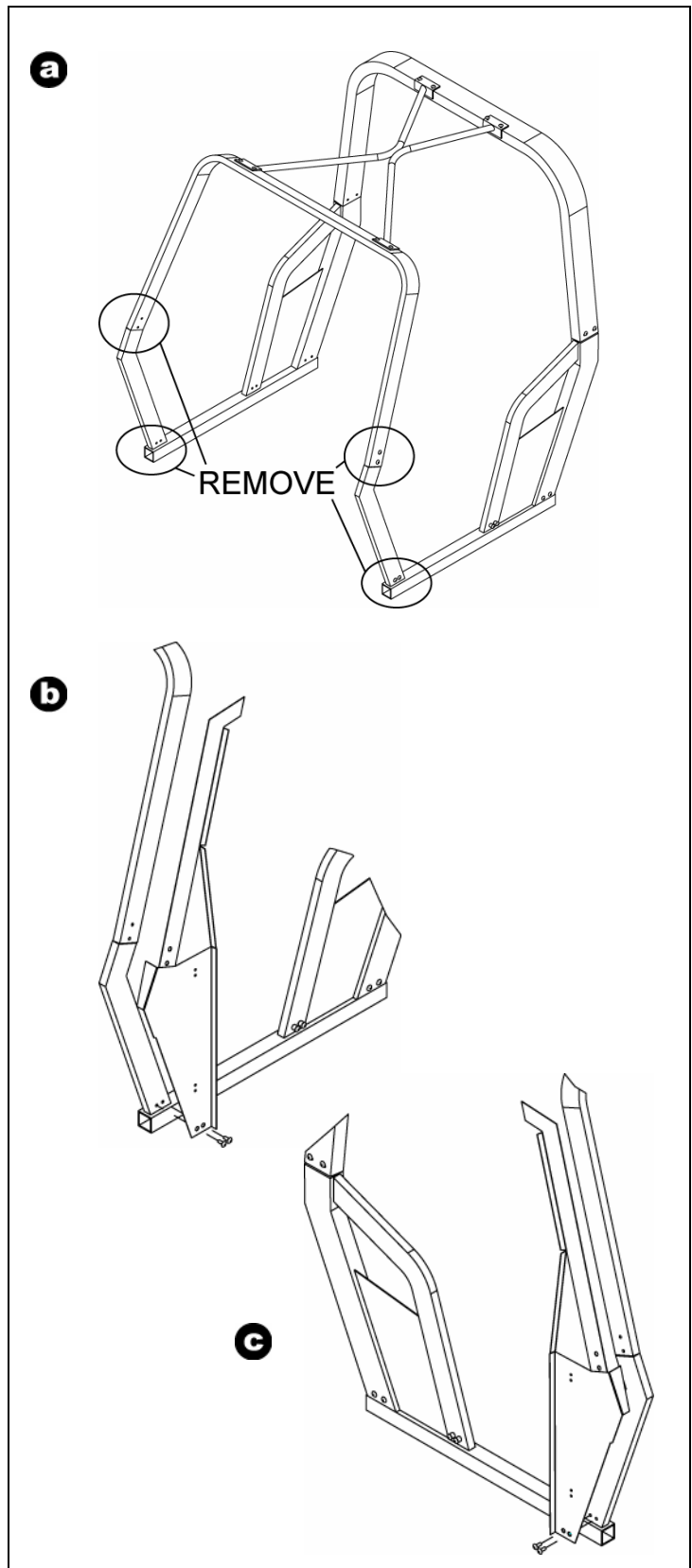

## 7. Install Rear Driver Side Panel

a) Before installing the rear side panels, removed the 12 machine screws from the roll bar as shown using T-30 Torx screwdriver. Do not discard screws. They are used to retain the rear side panels.

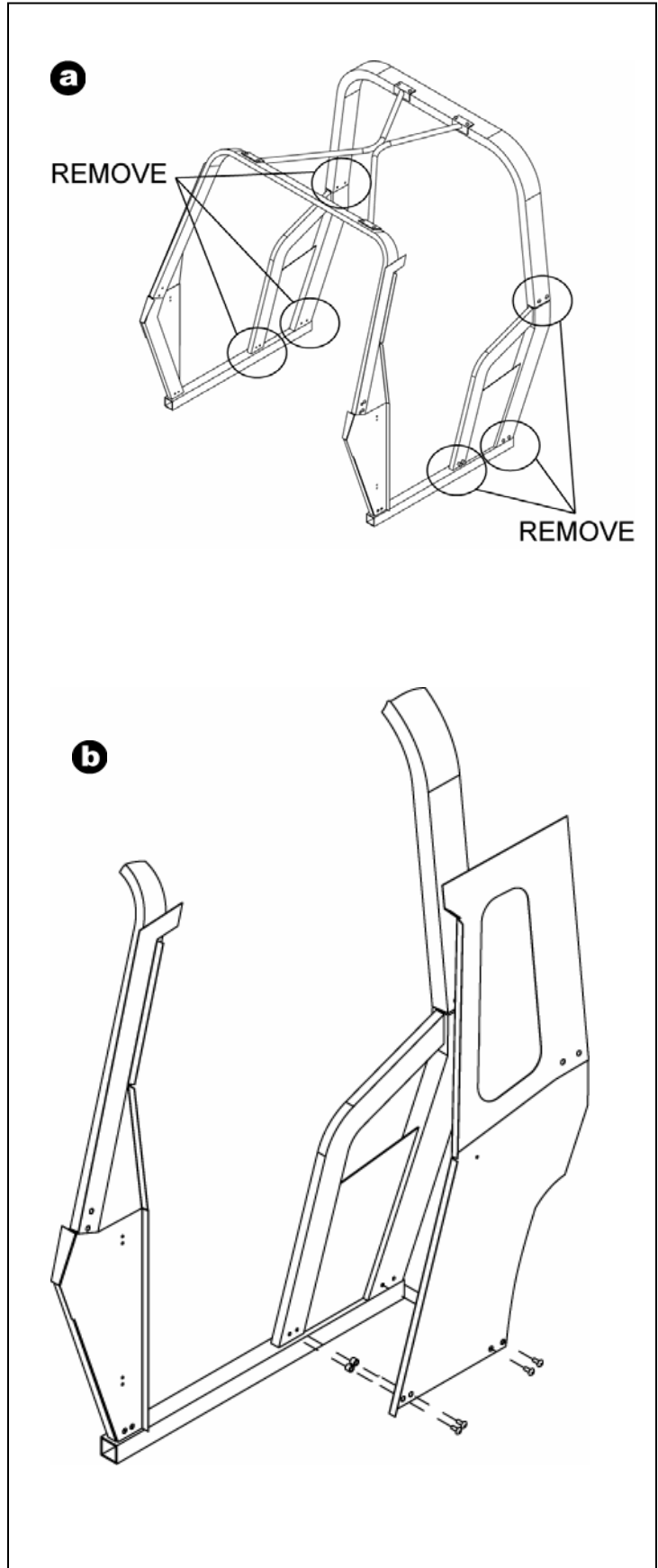

b) Install rear driver side panel using four (4) machine screws previously removed plus two (2) round spacers as shown in figure on the right. Note: Do not install remaining two screws yet. These will be installed after the back panel is assembled.

## 8. Install Rear Passenger Side Panel

a) Before installing the rear passenger side panel, remove the passenger seat. (Not shown)

b) Remove the four (4) screws retaining the plastic seat support using T-30 Torx screwdriver.

c) Remove the four (4) speed nuts retaining the fuel filler bezel using an 11mm wrench. Remove the plastic fuel bezel and fuel filler cap.

**WARNING: Do not drop anything into the fuel filler pipe. Doing so could cause engine damage.**

d) Install plastic fuel bezel in rear passenger side panel as shown.

e) Install rear passenger side panel with fuel bezel using four speed nuts previously removed. Also use four (4) machine screws previously removed plus two (2) round spacers as shown in figure on the right.

Note: Do not install remaining two screws yet. These will be installed after the back panel is assembled.

f) Reinstall fuel filler cap, seat bracket and seat. (Not shown)

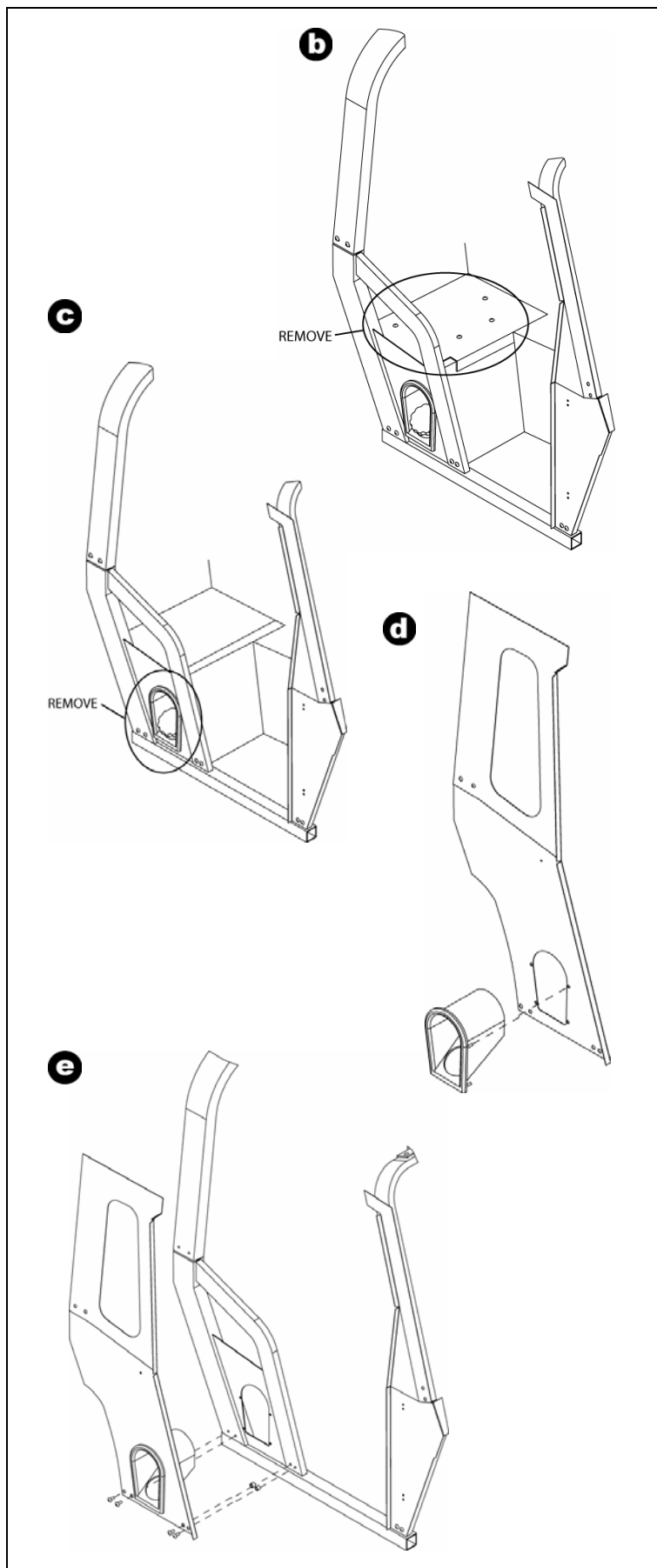

## 9. Install Back Panel

**Warning:** Installing the back panel requires two people to avoid injury or damage to the ATV or parts.

a) Before installing the back panel, remove the eight (8) screws retaining the top of the roll bar cross member as shown using T-30 screwdriver. Remove two screws retaining third brake light. Carefully pull out and unplug brake light. Do not discard any hardware.

**Warning:** To avoid damaging the cable for the third brake light, carefully pass the plug for the third brake light in the hole in the roof panel before setting in place.

b) Install back panel over both rear side panels as shown using four (4) machine screws previously removed and two (2) rear cover plates.

Do not install four (4) screws that retain the top of the back panel yet. These will be installed after the roof panel is assembled.

*Helpful Hint:* A rubber mallet can be used to carefully nudge parts so that holes align for screws.

Tighten all screws retaining rear side panels securely.

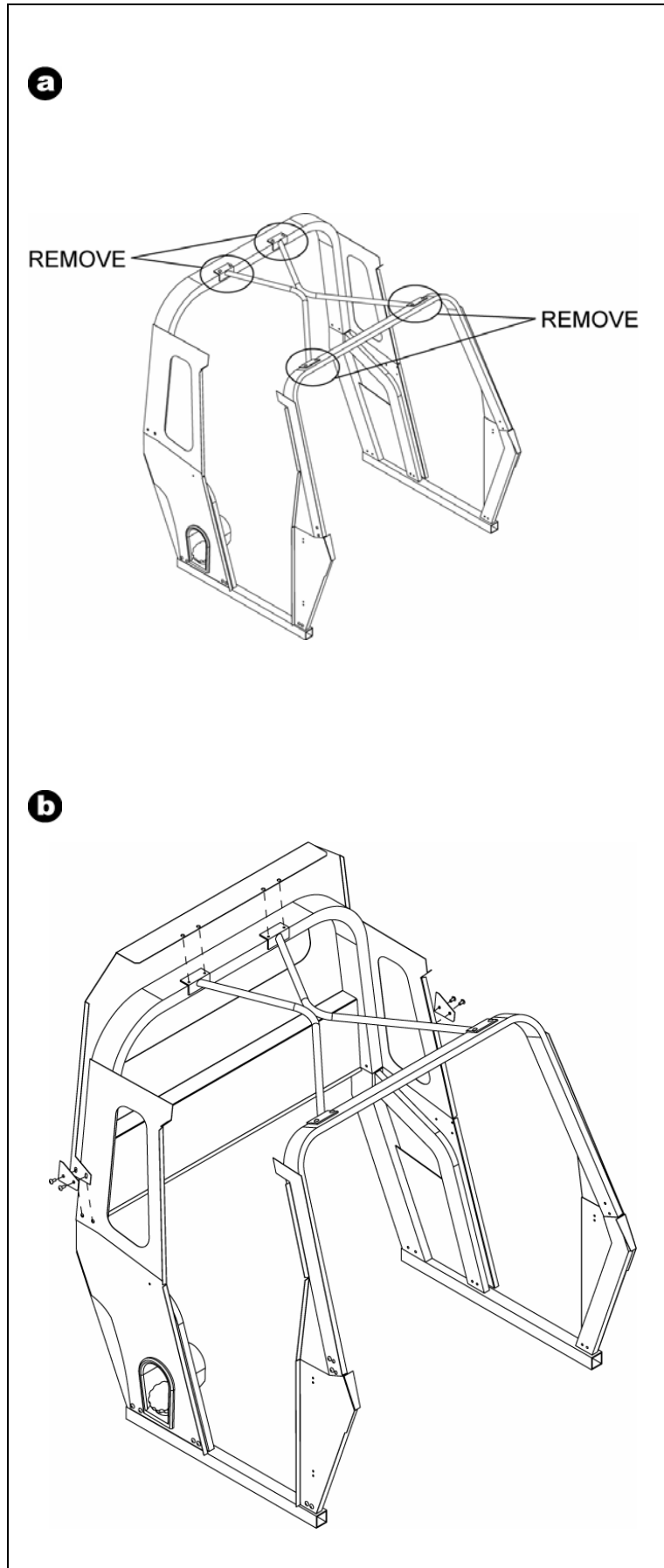

## 10. Install Windshield Panel

**Warning:** Installing the windshield panel requires two people to avoid injury or damage to the ATV or parts.

a) Install the windshield panel over both front side panels as shown using eight (8) machine screws previously removed and two (2) front cover plates.

*Helpful Hint:* A rubber mallet can be used to carefully nudge parts so that holes align for screws.

b) Tighten all screws retaining front side panels securely. (Not shown)

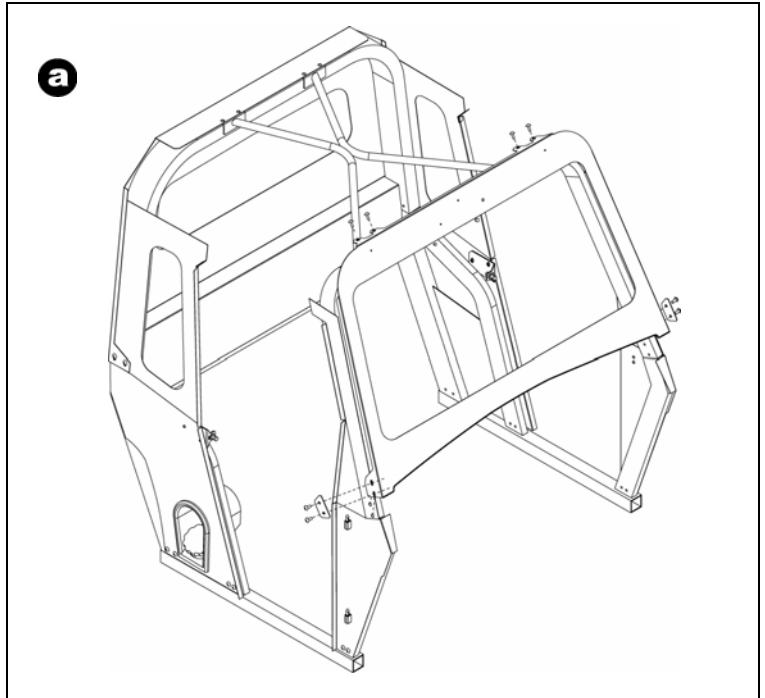

## 11. Install Roof Panel

**Warning:** Installing the roof panel requires two people to avoid injury or damage to the ATV or parts.

**Warning:** To avoid damaging the cable for the third brake light, carefully pass the plug for the third brake light in the hole in the roof panel before setting in place.

a) Install the roof panel over both the windshield panel and the back panel using four (4) machine screws previously removed.

Reinstall third brake light using two (2) screws previously removed. (Not shown)

Tighten all screws retaining roof panel securely. (Not shown)

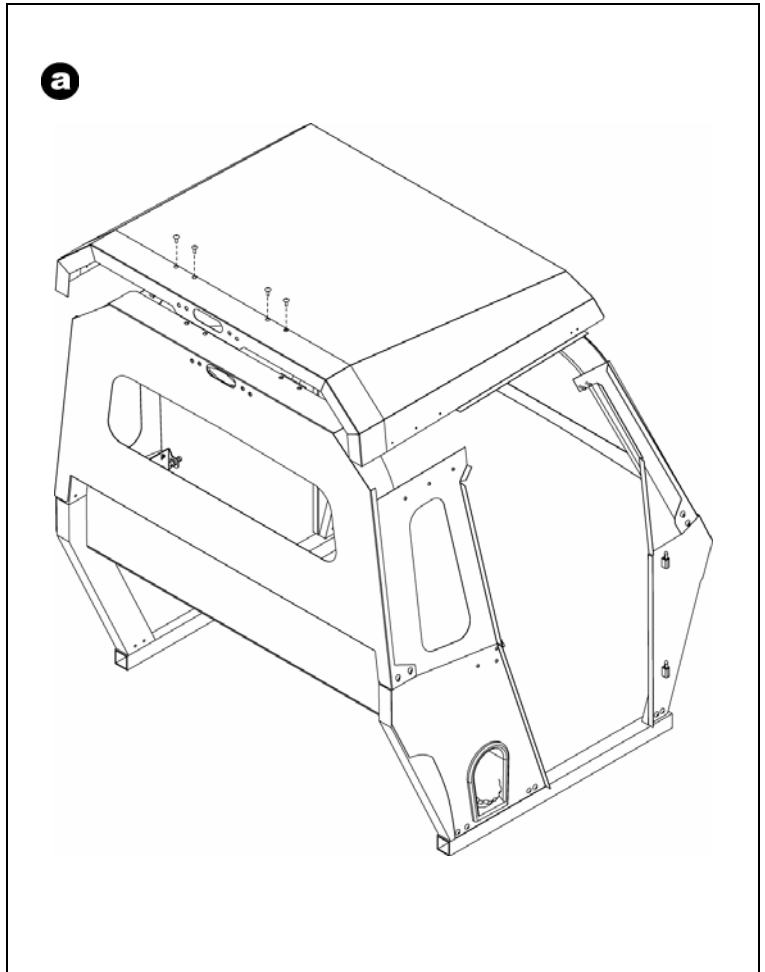

## 12. Drill roof and side panels

a) Finish installing the roof panel by drilling thirteen (13) holes as shown. Use existing holes in windshield panel and side panels to position drill. Use a 13/64" drill bit to drill the holes.

*Helpful Hint: A step drill will make much cleaner holes in sheet metal than a regular drill bit*

b) Once the holes are drilled, fasten the roof panel using thirteen (13) 10-32" x 3.4" screws and thirteen (13) 10-32 nylon lock nuts.

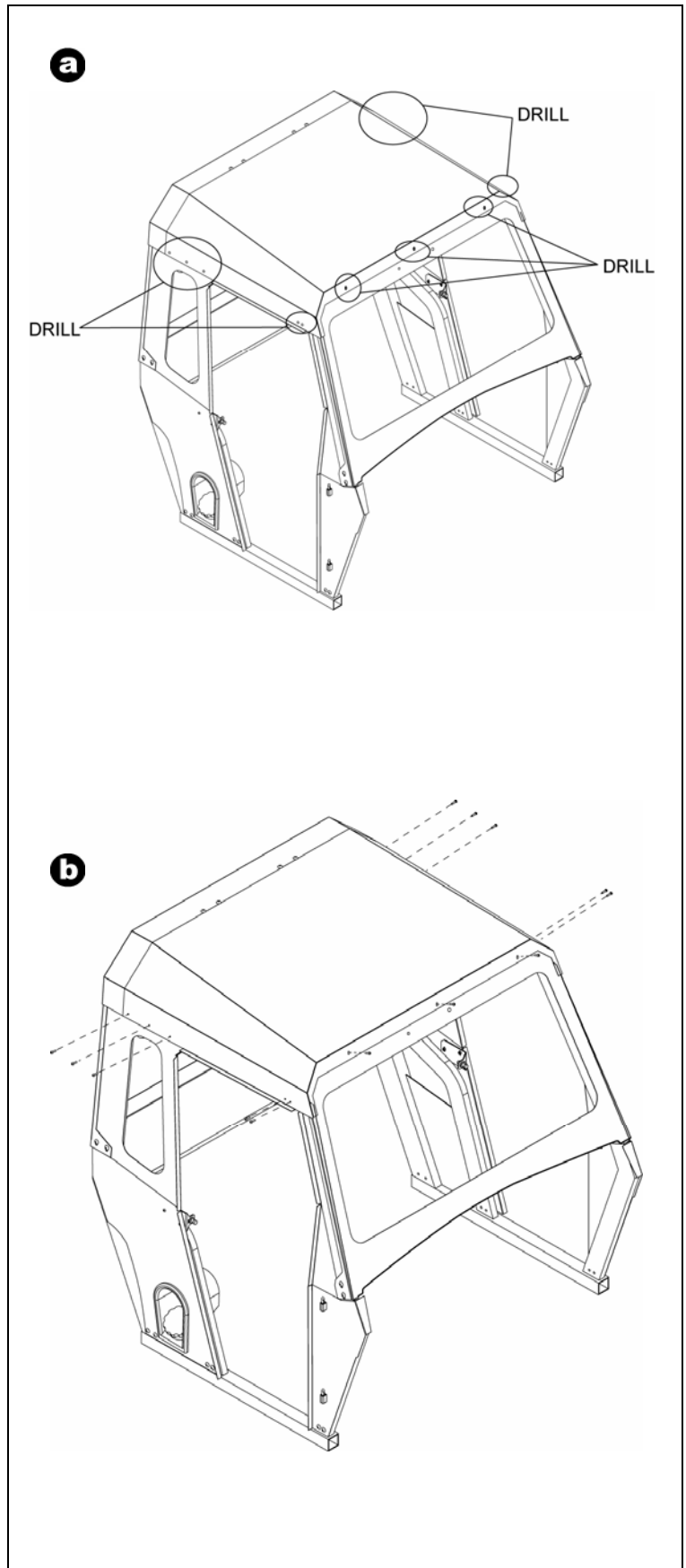

### 13. Install Gaskets and Trim

**Warning:** To avoid personal injury, do not use cab without installing gaskets as shown.

a) Install large protective trim to flange around door opening. Cut trim to proper length.

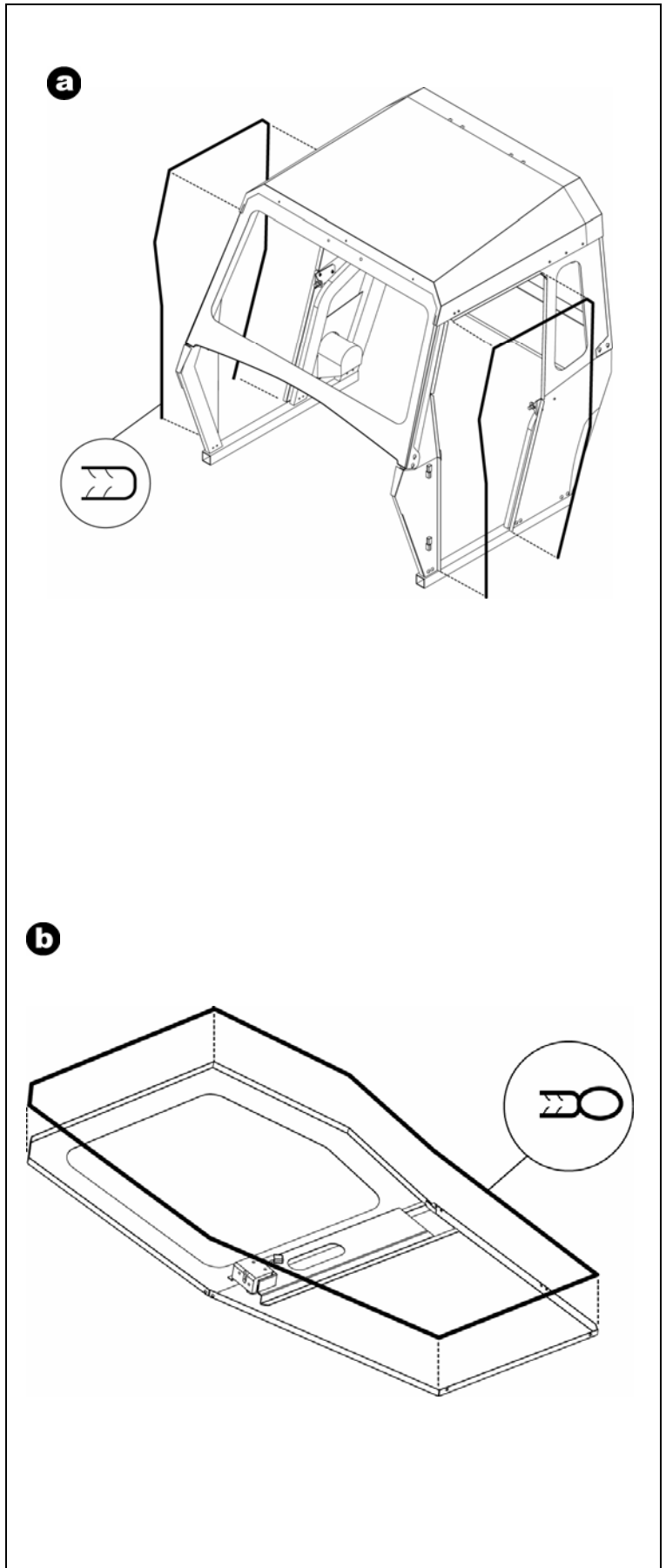

b) Install sealing gasket to both doors as shown. Cut gasket to length.

**Note:** Notch out retaining part of gasket to fit around hinges.

## 14. Install and Adjust doors

a) Install door as shown. Repeat procedure for other side.

b) Close door and tighten screws for striker plate and the nut on the striker bolt. Test door again, including the lock and key. If door does not latch properly, loosen and adjust striker bolt. Repeat until door closes properly. (Not shown)

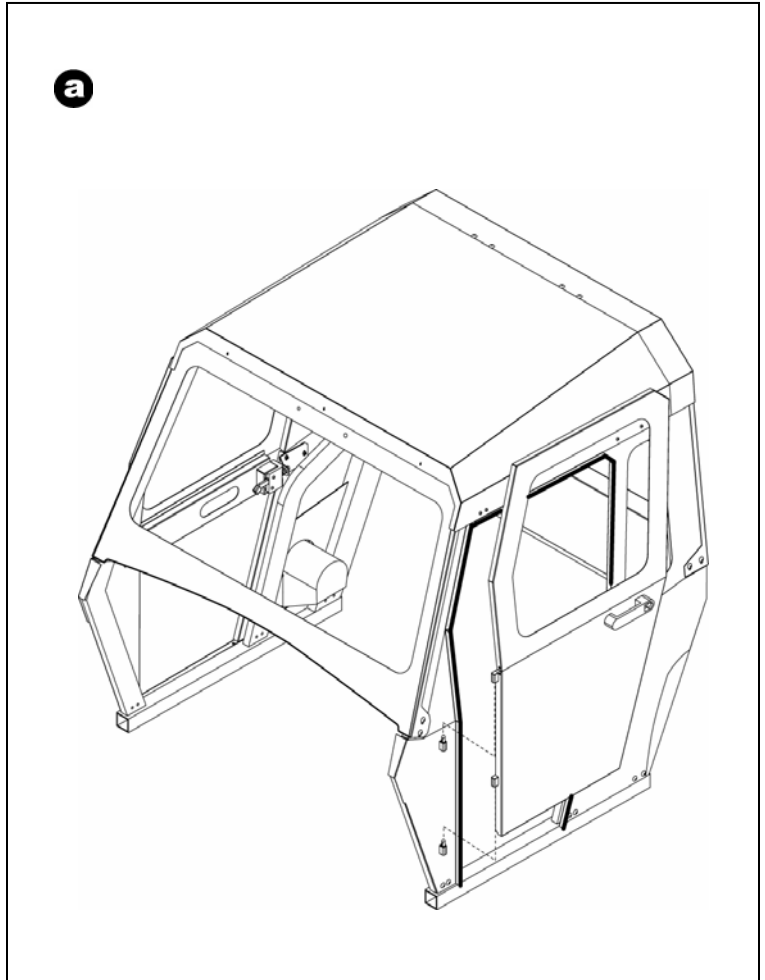

# OPERATION

The Beaver Pro hard cab with removable doors is very useful for work or play. It is perfect for the hunting, farming, fishing, commercial and recreational enthusiast. The cab and optional heater allow the full enjoyment of the Prowler in all weather conditions.

## **Removing the doors**

In warm weather or to load your ATV on a trailer, the doors of your Beaver Pro hard cab can be easily removed by opening the door and carefully lifting it off the hinges.

## **Cleaning your BeaverPro cab**

Use same mild soap and techniques used to clean your ATV.

# REPLACEMENT PARTS

Use this parts list to order replacement parts from BeaverPro.

10012	Window/Windshield Gasket
10035	Roof Panel
10036	Rear Panel
10037	Windshield Panel
10038	Front Driver Side Panel
10039	Front Passenger Side Panel
10040	Rear Driver Side Panel
10041	Rear Passenger Side Panel
10042	Driver Side Door
10043	Passenger Side Door
10044	Hinge
10045	Latch
10046	Latch Bolt
10047	Striker Plate
10048	Handle
10049	Handle Shim
10050	Keys
10051	Small Plug
10052	Large Plug
10053	10-32" x 1/4" Screw
10054	10-32" x 1/2" Screw
10055	10-32" x 3/4" Screw
10056	10-32" Nylon Lock Nut
10057	M6 x 16mm Screw
10058	Sealing Gasket
10059	Large Protective Trim
10060	Small Protective Trim
10061	Round Spacer 10mm ID x 12mm Long
10062	Windshield
10063	Side Window
10064	Door Window
10067	Front Cover Plate
10068	Rear Cover Plate

To order replacement parts, contact the Parts Department at:

LB Manufacturing Inc.  
671 Babin Street, Dieppe Industrial Park,  
N.B. Canada E1A 5M7  
Ph: (506) 388-3335 Fax (506) 388-3325  
[www.beaverpro.com](http://www.beaverpro.com)  
[lucb@beaverpro.com](mailto:lucb@beaverpro.com)

Manual Revision: 01.4

Date: Sept. 18, 2006