

Save this manual for future reference.

Beaver Pro™

Owner's Manual

Model:
Yamaha Rhino
Cab Kit *

Caution:

Before using this product, read this manual and follow all Safety Instructions.

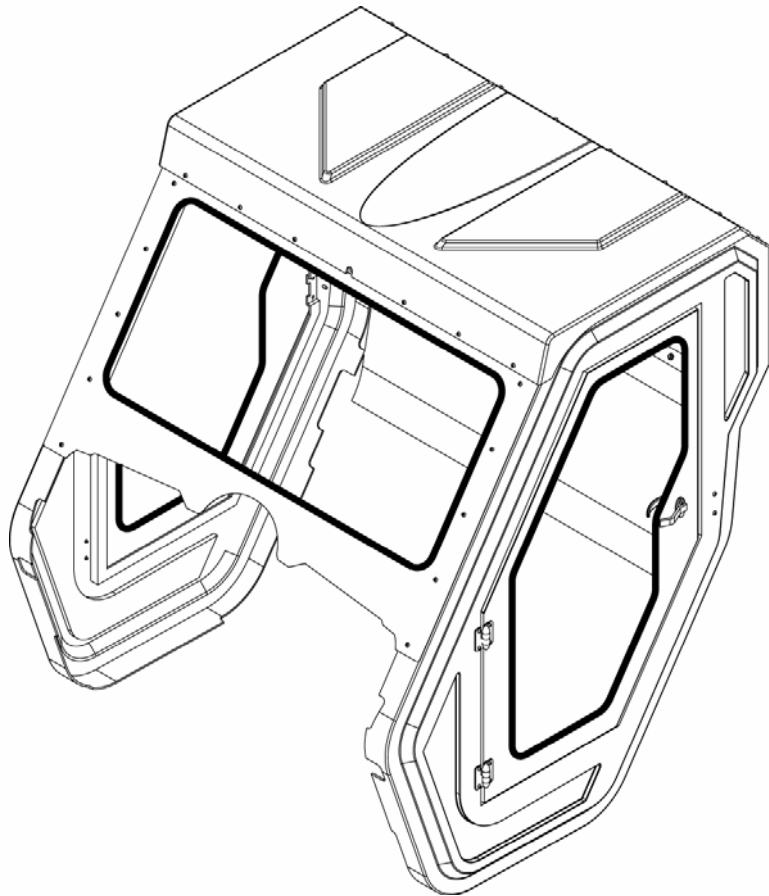

BEAVER PRO

Yamaha Rhino Cab Kit*

- Safety Instructions
- Cab Kit Contents
- Hardware Assembly
- Panel Assembly
- Operation
- Replacement Parts

*The Beaver Pro cabs and accessories are in no way affiliated with the Yamaha Motor Corporation. Any use of the Yamaha name is only to identify their utility vehicle as it pertains to our accessories. Yamaha and Rhino are registered trademarks of the Yamaha Motor Corporation.

Warning: Failure to heed all safety and operating instructions and warnings regarding use of this product can result in serious bodily injury.

SAFETY INSTRUCTIONS

Read entire assembly instructions before beginning work.

Install all parts indicated in assembly instructions. Failure to fully assemble product before use could result in personal injury.

Assembly of product requires use of hand or power tools. If you are not experienced in using these types of tools, have product dealer do the install for you.

Some parts contain sharp edges as indicated in the manual. Wear protective gloves if necessary.

Dress for safety. DO NOT wear loose clothing, gloves, neckties or jewelry if using power tools to assemble this product.

Always keep your assembly area clean, uncluttered and well lit.

Keep visitors and children a safe distance away from the assembly area. Visitors should wear the same safety equipment described above.

Never operate your ATV with the cab doors open. Failure to properly latch the doors before moving the vehicle could result in serious injury.

CAB KIT CONTENTS

Your BeaverPro™ Yamaha Rhino cab kit should contain the parts listed below. Separate all parts from packing materials. Do not discard packing material until assembly is complete. Item quantities are listed in parenthesis below.

Panels and Doors

- Roof Panel (x1)
- Rear Panel (x1)
- Windshield Panel (x1)
- Driver Side Panel (x1)
- Passenger Side Panel (x1)
- Driver Side Door (x1)
- Passenger Side Door (x1)
- Window for Door (x2)
- Driver Side Panel Bracket (x1)
- Passenger Side Panel Bracket (x1)
- Adjuster Plate (x4)
- Rubber Dust Shield (x1)
- Baton Strip (x1)

Hardware

- Hinges, Right Hand (x2)
- Hinges, Left Hand (x2)
- Striker Plate, Left (x1)
- Striker Plate, Right (x1)
- ¼"-20 x 5/8" Screws (x75)
- ¼"-20 x 3/4" Screws (x16)
- ¼"-20 Nylon Lock Nuts (x91)
- ¼" Washers (x91)
- Outside Handle (x2)
- Inside Handle (x2)
- Cams (x2)
- 10-24 x ¾" Flat, Hex Screw (x4)
- 10-24 Nylon Lock Nuts (x4)
- Self Tapping Screws (x6)
- Hard Gasket (1 Roll 25ft)
- Soft Gasket (1 Roll 25ft)
- Small Protective Trim (6ft)



TOOLS REQUIRED FOR ASSEMBLY

Ensure that you have the following tools available before you begin the assembly of your BeaverPro™ Yamaha Rhino cab kit. Note: Assembly requires two people.

- Phillips Screwdriver
- 7/16" Wrench
- Electric drill
- 1/4" drill bit
- 5/32" drill bit
- Utility knife
- Wood clamps or Locking Pliers
- Rubber Mallet

HARDWARE ASSEMBLY

In this section, you will be instructed on how to pre-assemble all hardware onto the panels prior to the panel assembly. The hardware assembly should take about 30 minutes to complete.

1. Assemble Hinges

a) Install both hinge leaves on driver side door using four (4) $\frac{1}{4}$ "-20 x $\frac{5}{8}$ " screws, four $\frac{1}{4}$ " washers and four $\frac{1}{4}$ "-20 nylon lock nuts. Ensure hinges are oriented as shown in figure to the right.

b) Install both hinge leaves on passenger side door using four (4) $\frac{1}{4}$ "-20 x $\frac{5}{8}$ " screws, four (4) $\frac{1}{4}$ " washers and four (4) $\frac{1}{4}$ "-20 nylon lock nuts. Ensure hinges are oriented as shown in figure to the right.

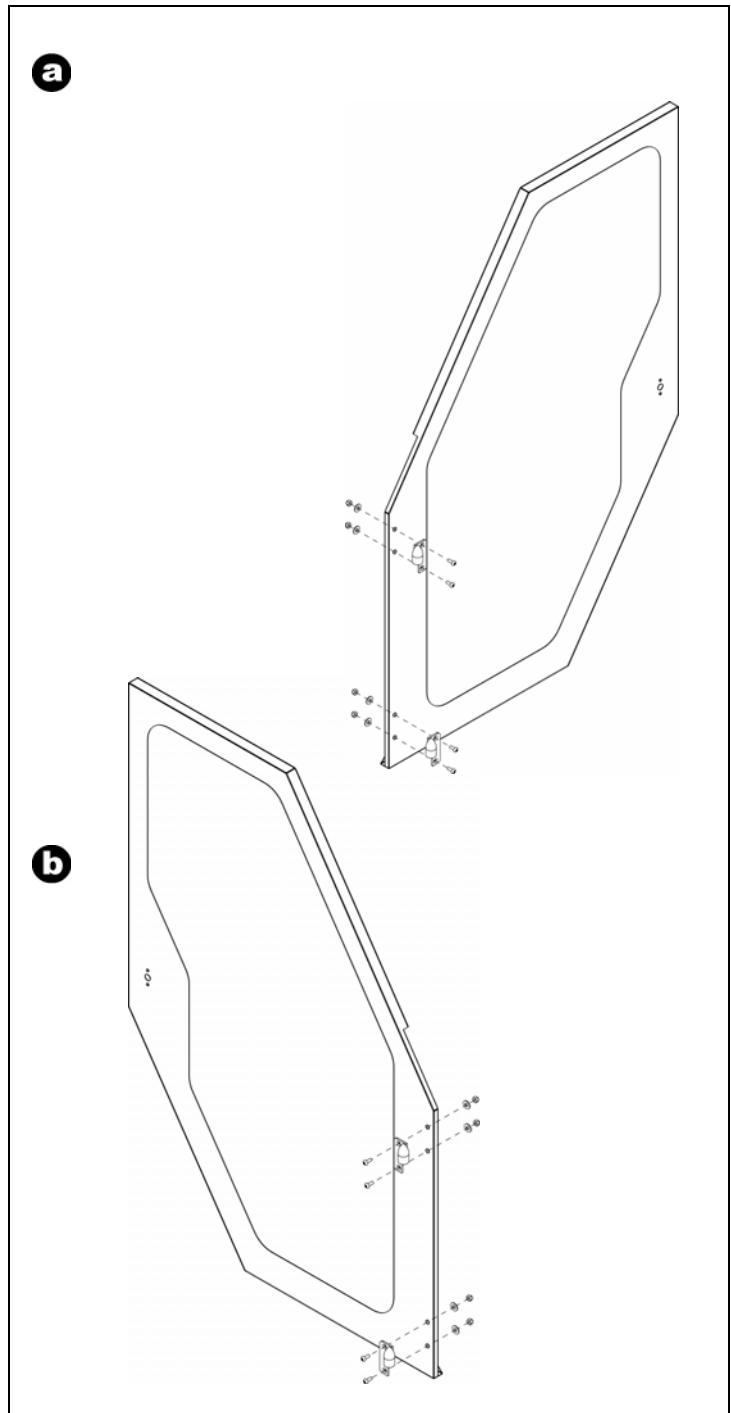

c) Install outside handle, inside handle and cam on driver door using two (2) 10-24 x 3/4" flat hex screws and two (2) 10-24 nylon lock nuts. Ensure parts are oriented as shown in figure to the right.

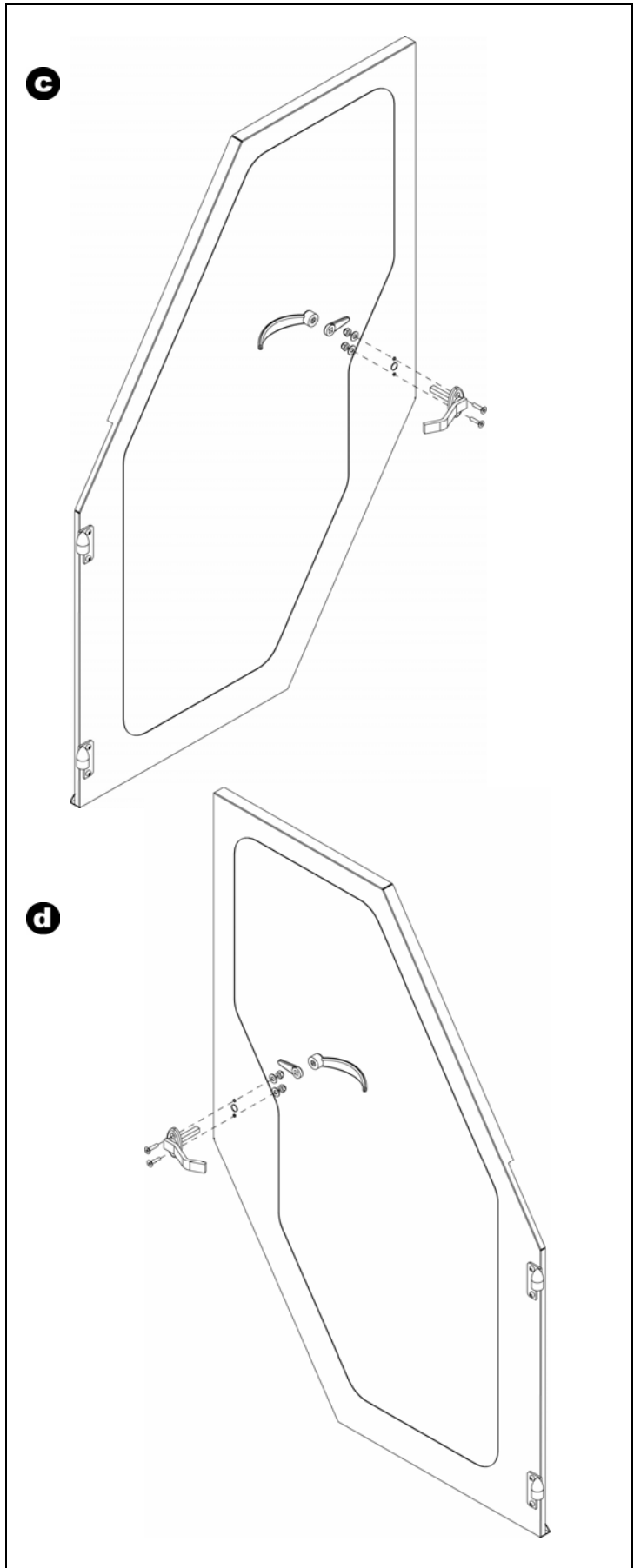

d) Install outside handle, inside handle and cam on passenger door using two (2) 10-24 x 3/4" flat, hex screws and two (2) 10-24 nylon lock nuts. Ensure parts are oriented as shown in figure to the right.

2. Install Gaskets in Side Panels

a) Cut several 3" lengths of hard gasket and install as shown about every foot around perimeter of side panel. Repeat for second panel.

a

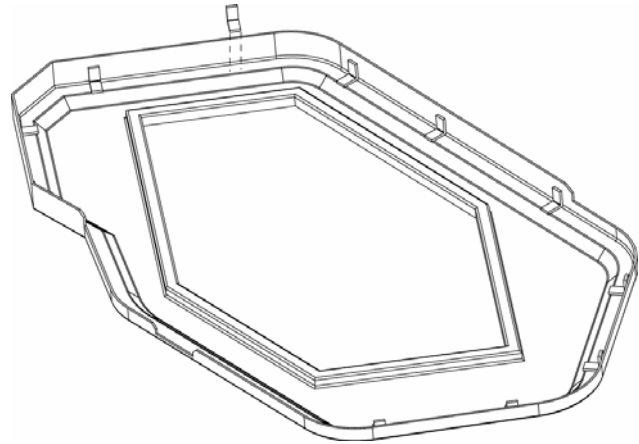

b) Install a length of soft gasket around perimeter of door opening in panel. Repeat for second panel.

b

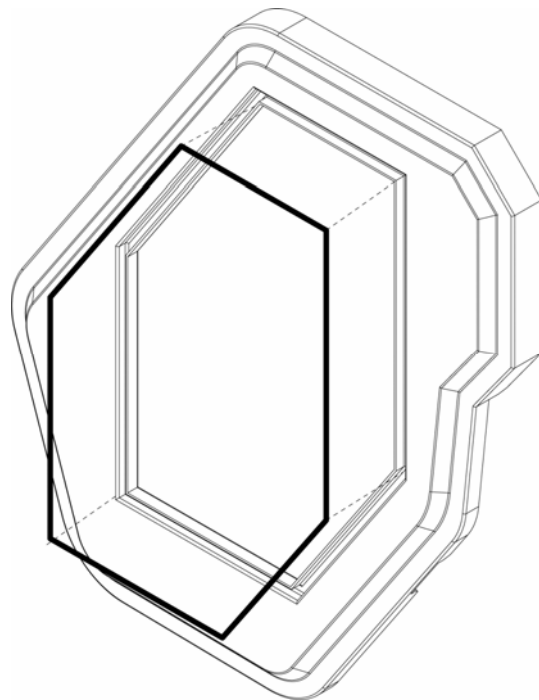

3. Pre-assemble Roof and Windshield Panel

a) Clamp the roof and windshield panel in the position shown on the right. Line up edge of roof panel with the bend line in the windshield panel.

b) Drill six (6) holes in the roof panel using the existing holes in the windshield panel as a guide. Use $\frac{1}{4}$ " drill bit to drill holes. (Not shown)

c) Assemble the roof panel and the windshield panel together using six (6) $\frac{1}{4}$ "-20 x $\frac{5}{8}$ " screws, six (6) $\frac{1}{4}$ " washers and six (6) $\frac{1}{4}$ "-20 nylon lock nuts.

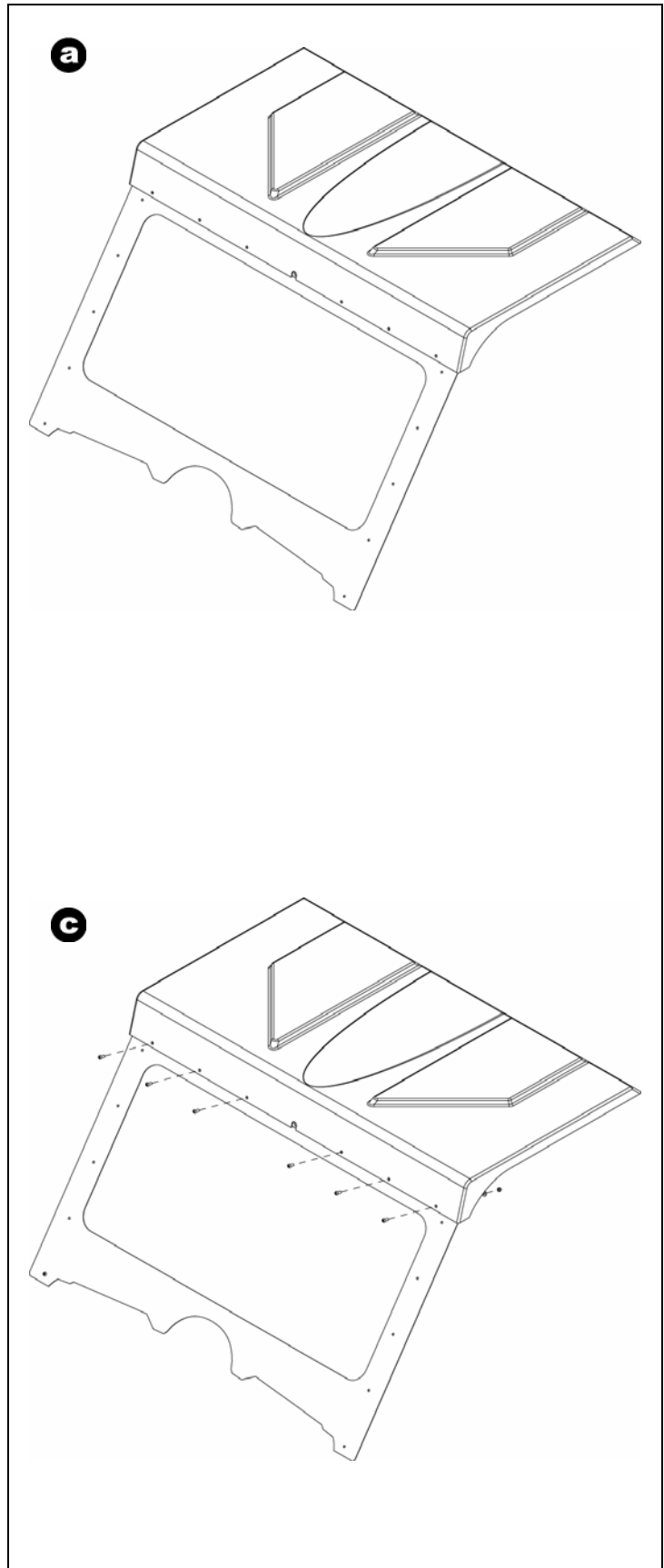

4. Install Protective Trim

a) Install small protective trim to bottom of windshield panel as shown. Cut from length of trim provided

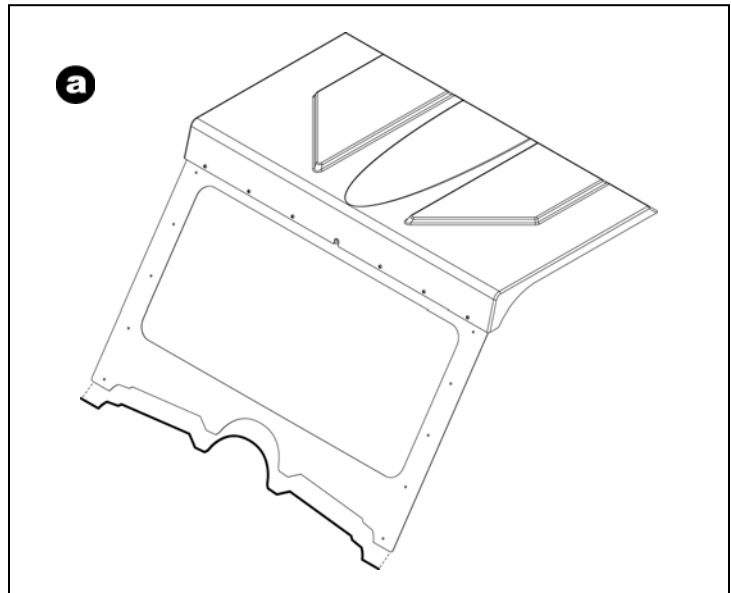

5. Pre-Assemble Dust Shield and Back Panel

a) Clamp back panel, rubber dust shield and baton strip together in position shown. Line up holes in baton strip with holes in back panel. Line up edge of rubber dust shield with edge of baton strip.

b) Drill seven (7) holes through the rubber dust shield using a $\frac{1}{4}$ " drill bit. (Not shown)

c) Assemble the back panel, dust shield and baton strip together using seven (7) $\frac{1}{4}$ "-20 x $\frac{5}{8}$ " screws, seven (7) $\frac{1}{4}$ " washers and seven (7) $\frac{1}{4}$ "-20 nylon lock nuts.

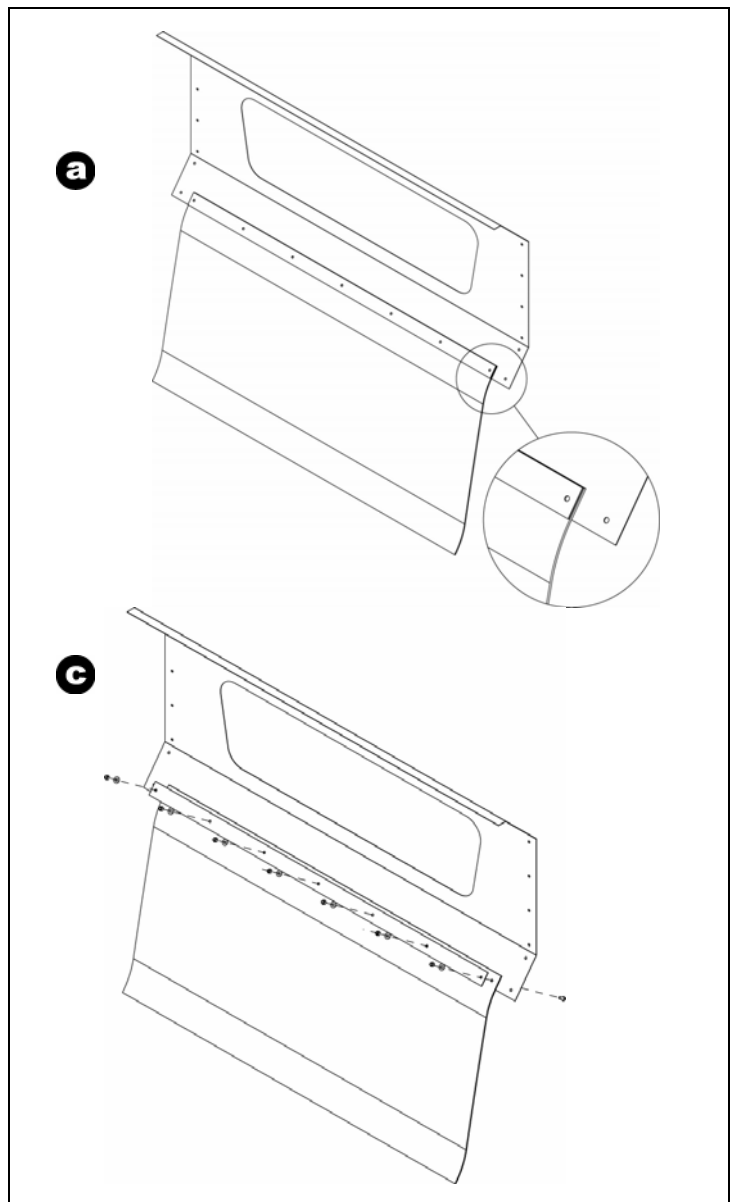

PANEL ASSEMBLY

6. Install Side and Back Panels

a) Install side panels in position shown on right and clamp tightly in place.

b) Install back panel/dust shield assembly in position shown on right and clamp tightly in place.

c) Drill sixteen (16) holes using $\frac{1}{4}$ " drill bit. Use existing holes in back panel as drill guide. (Not shown)

d) Assemble the back panel assembly and side panels using sixteen (16) $\frac{1}{4}$ "-20 x $\frac{5}{8}$ " screws, sixteen (16) $\frac{1}{4}$ " washers and sixteen (16) $\frac{1}{4}$ "-20 nylon lock nuts.

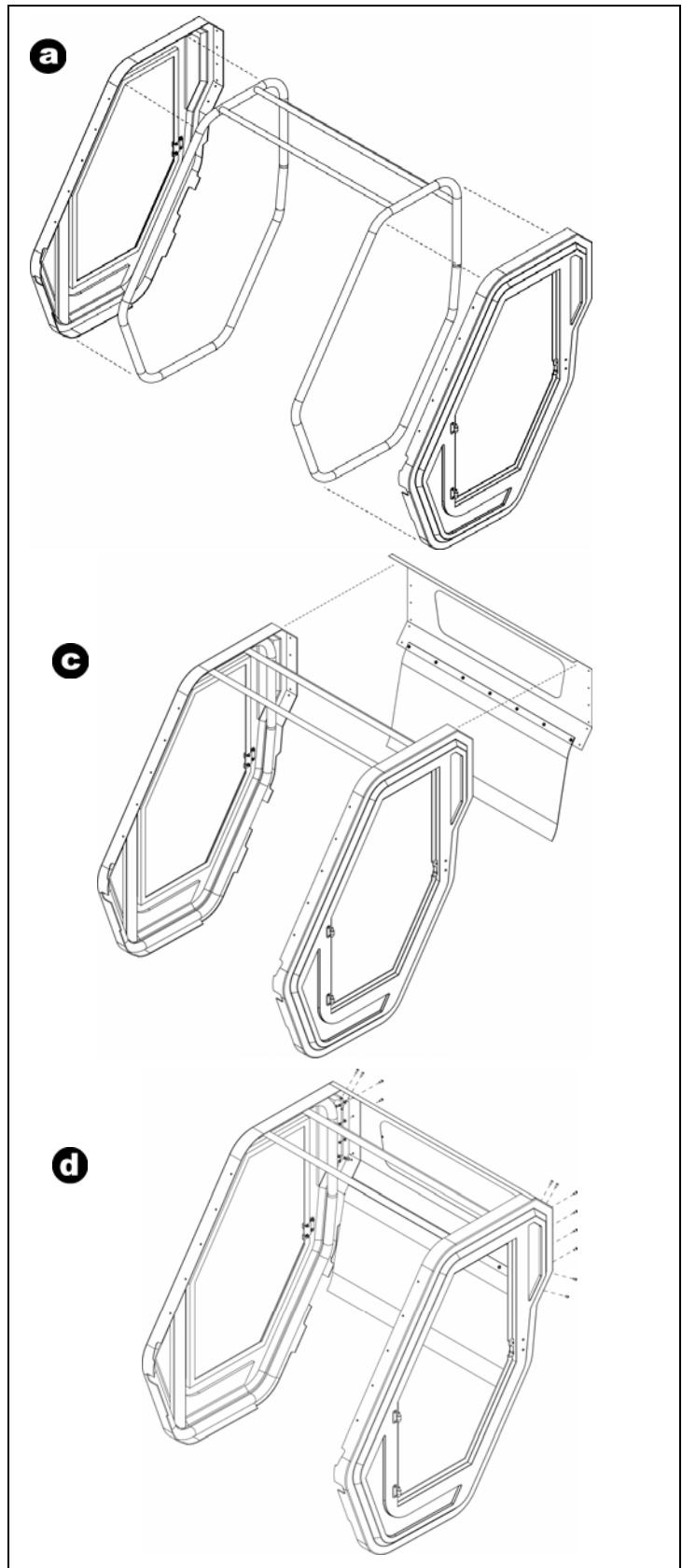

7. Install Roof Panel Assembly

a) Install roof assembly in position shown on right and clamp tightly in place.

NOTE: Cut and install a length of hard gasket on the hood of the Rhino ATV where the windshield panel contacts the plastic body panel. This will prevent scuffs marks on your Rhino body panel.

b) Drill seventeen (17) holes using $\frac{1}{4}$ " drill bit. Use existing holes in windshield and back panel as drill guide. (Not shown)

c) Assemble the roof panel assembly to the side panels using seventeen (17) $\frac{1}{4}$ "-20 x $\frac{5}{8}$ " screws, seventeen (17) $\frac{1}{4}$ " washers and seventeen (17) $\frac{1}{4}$ "-20 nylon lock nuts.

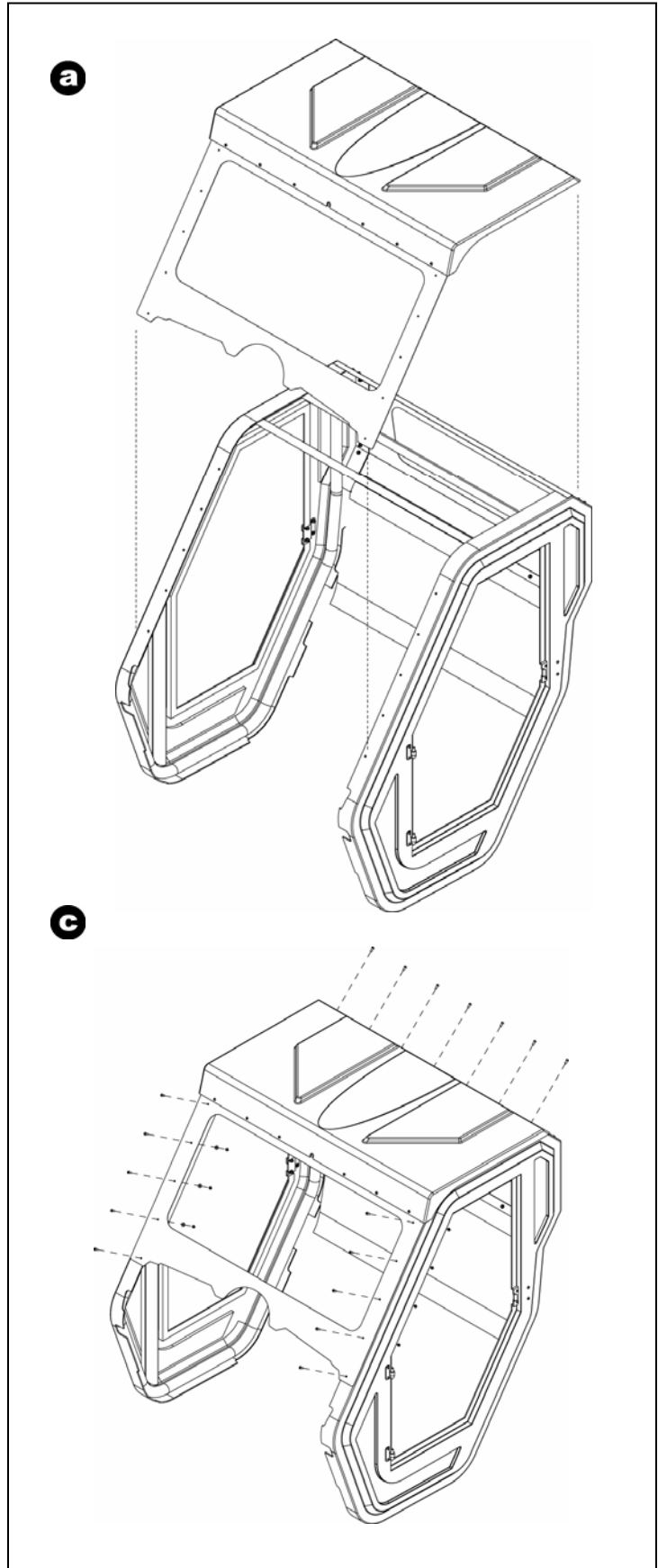

8. Secure Side Panels with Self-Tapping Screws (Optional Step)

Warning: Drilling holes in your Rhino roll bar could void your warranty. This step is not mandatory for proper function of your Rhino cab kit. It is however recommended for a Rhino that will see heavy duty usage.

a) Drill six (6) pilot holes using a 5/32" drill bit in approximate area shown. Drill through the plastic side panel into the roll bar.

b) Secure the side panels with six (6) self-tapping screws supplied. (Not shown)

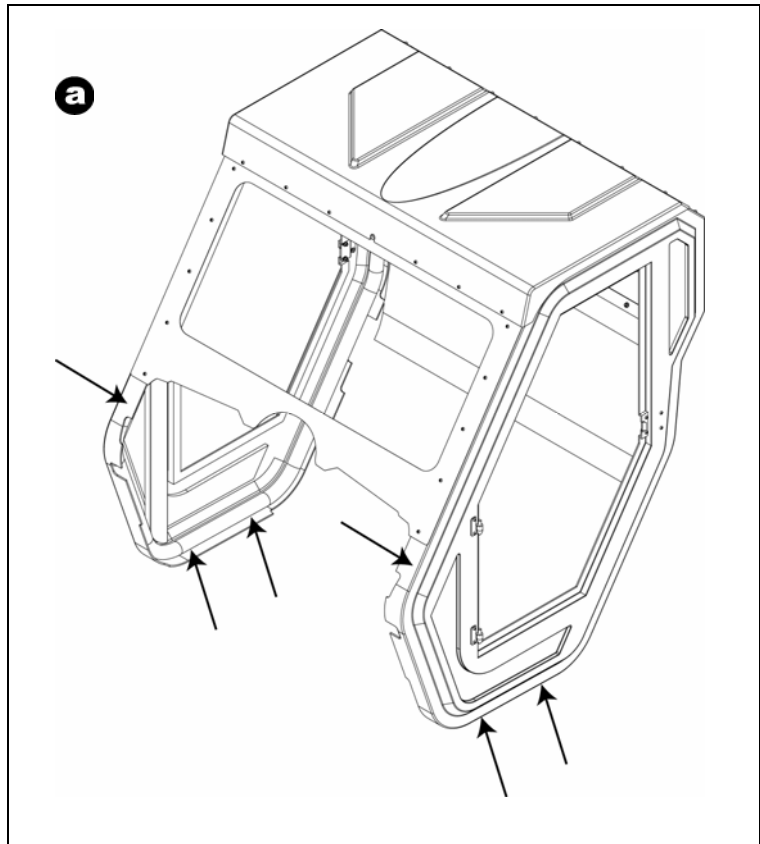

9. Install Doors

a) Position door evenly in door opening and shim or clamp in place. Install second half of hinges and drill 1/4" holes through plastic side panel. Install hinges with four (4) 1/4"-20 x 5/8" screws and four (4) nylon lock nuts.

b) Repeat for second side. (Not shown)

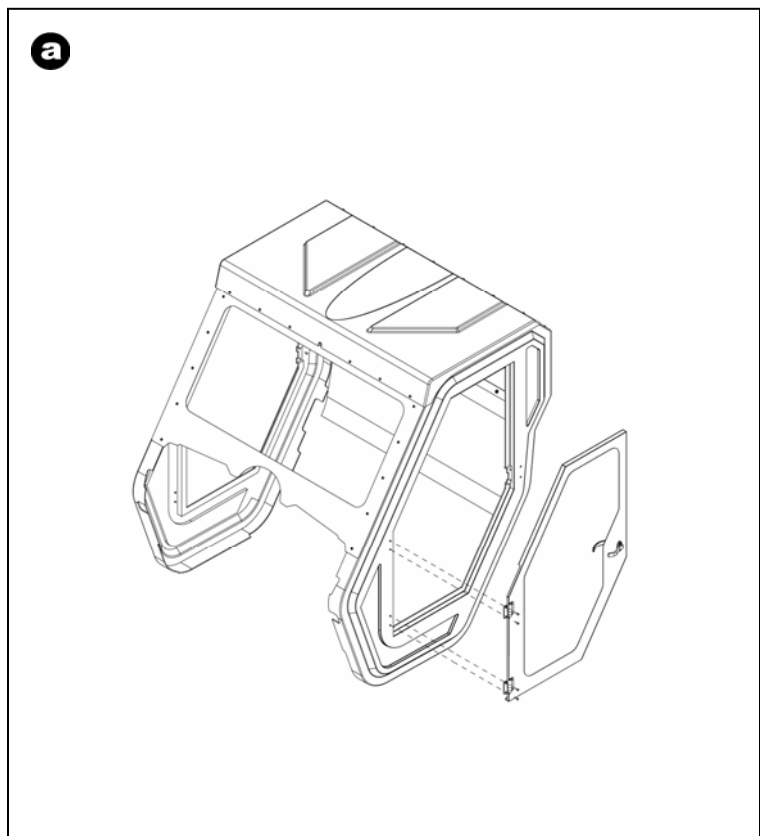

10. Install Striker Plates

a) Position striker plate in panel so that door closes properly. Drill two holes using $\frac{1}{4}$ " drill bit. Use two (2) $\frac{1}{4}$ "-20 x $\frac{3}{4}$ " screws, two (2) $\frac{1}{4}$ "-20 nylon lock nuts and two (2) $\frac{1}{4}$ " washers to secure striker plate.

b) Repeat for other side.

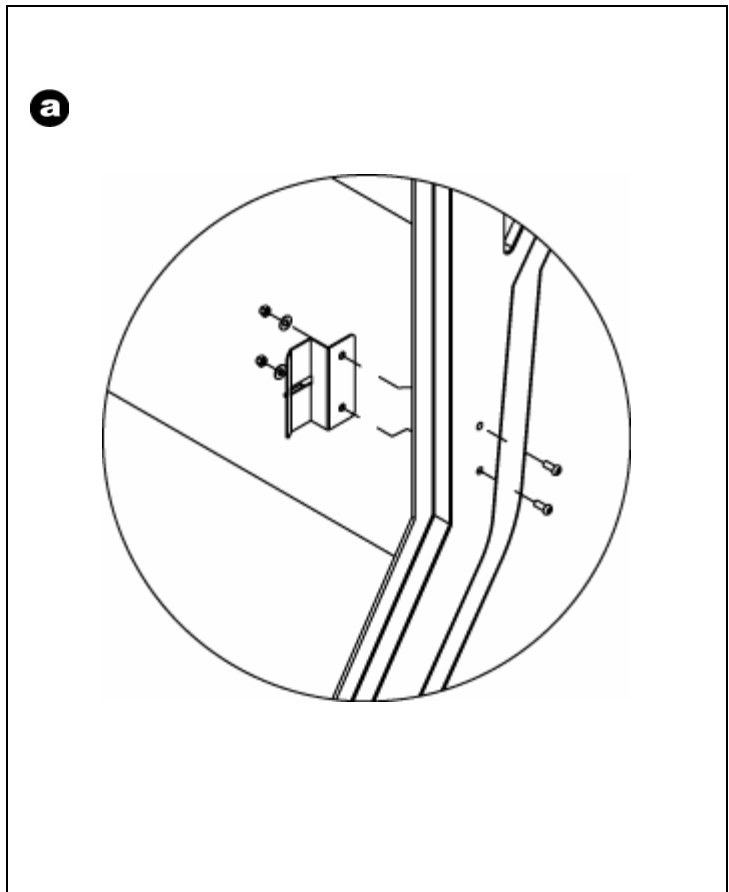

OPERATION

The Beaver Pro hard cab with removable doors is very useful for work or play. It is perfect for the hunting, farming, fishing, commercial and recreational enthusiast. The cab and optional heater allow the full enjoyment of the Rhino in all weather conditions.

Removing the doors

In warm weather or to load your ATV on a trailer, the doors of your Beaver Pro hard cab can be easily removed by opening the door and carefully lifting it off the hinges.

Cleaning your BeaverPro cab

Use same mild soap and techniques used to clean your ATV.

REPLACEMENT PARTS

Use this parts list to order replacement parts from BeaverPro.

10001	Front (Windshield) Panel
10002	Rear Panel
10005	Baton Strip
10008	Roof
10009	Windshield
10012	Windshield Gasket
10022	1/4"-20 Nylon Lock Nut
10023	1/4"-20 Screw x 5/8"
10060	Small Protective Trim
10066	Rubber Dust Shield
10069	1/4" Flat Washer, Zinc
10071	10-16 Self Tapping Screw
10081	Driver Side Door
10082	Passenger Side Door
10083	Driver Side Panel
10084	Passenger Side Panel
10085	Hinge RH, Black Plastic
10086	Hinge LH, Black Plastic
10087	Door Striker, Left
10088	Window for Door
10089	Hinge RH, Torpedo Chrome
10090	Hinge LH, Torpedo, Chrome
10091	1/4"-20 Screw x 3/4"
10097	Handle, Outside
10098	Door Striker, Right
10099	Cam
10100	Handle, Inside
10101	Rear window, Plain Glass
10102	Rear window, Sliding Glass
10103	10-24 Nylon Lock Nut, St/St
10104	10-24 x 3/4"Hex Screw, St/St
10105	Hard Gasket,
10106	Soft Gasket

To order replacement parts, contact the Parts Department at:

LB Manufacturing Inc.
671 Babin Street, Dieppe Industrial Park,
N.B. Canada E1A 5M7
Ph: (506) 388-3335 Fax (506) 388-3325
www.beaverpro.com
lucb@beaverpro.com

Manual Revision: 01.1

Date: Oct. 16, 2006